

QUICK START GUIDE



Smart LITHIUM-ION Battery Series

38.4V/51.2V/76.8V

OPTIONAL ACCESSORY

Easy Installation Parts:



Battery Mounting Ears



Switch Cable



CAN LCD Gauge(Meter)



25A CAN Charger



Charge Port



US Charging Cable

Mounting Bracket

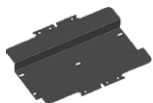

Clubcar-Precedent



EZGO-TXT



EZGO-RXV

DC-DC Converter



DC48V-12V 60A

Power Cable



P+(red) / P-(black)
Extension Cable

TOOLS NEEDED

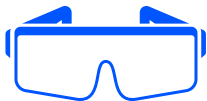

Eye protection



gloves



Cables



13mm socket



Insulated torque wrench

BATTERY INTERFACE

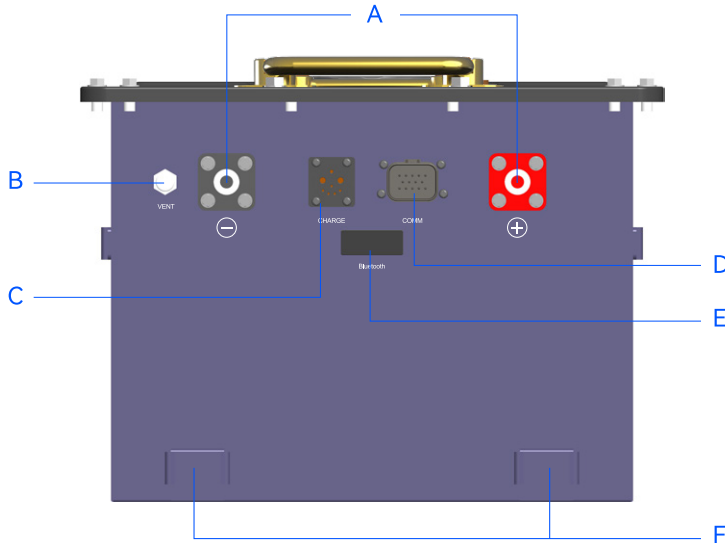

- A. Power Terminals (M8 threads)
- B. VENT
- C. CHARGE
- D. COMM
- E. Bluetooth
- F. Mounting Feet

SAFETY



Turn batteries off during installation.



Wear proper personal protective equipment (eye protection and gloves).



Use insulated tools.



Do not wear jewelry or other metallic objects when handling batteries.



Keep sparks and flames away from batteries. This includes sources of static electricity.



Use cables of appropriate length and gauge.
(See OLELON Series Lithium-Ion User's Guides for specific cable sizes)



Ensure the charger is set as recommended.
(See OLELON Series Lithium-Ion User's Guides for charger recommendations)



Prior to connecting, make sure the charger is off or disconnected.



Do not attempt to open the battery case.



Review product warning labels and OLELON Series Lithium-Ion User's Guides.

BATTERY INSTALLATION

The Lithium-ion battery voltage must be matched to the vehicle where it is installed. Before installation, ensure the battery has sufficient charge. Only turn on the battery switch after all wiring has been completed.



DO NOT CONNECT BATTERIES IN A SERIES OR PARALLEL. SERIES & PARALLEL CONNECTION MAY POSE DANGER TO USER AND/OR INSTALLER AND CAUSE DAMAGE TO THE BATTERY.

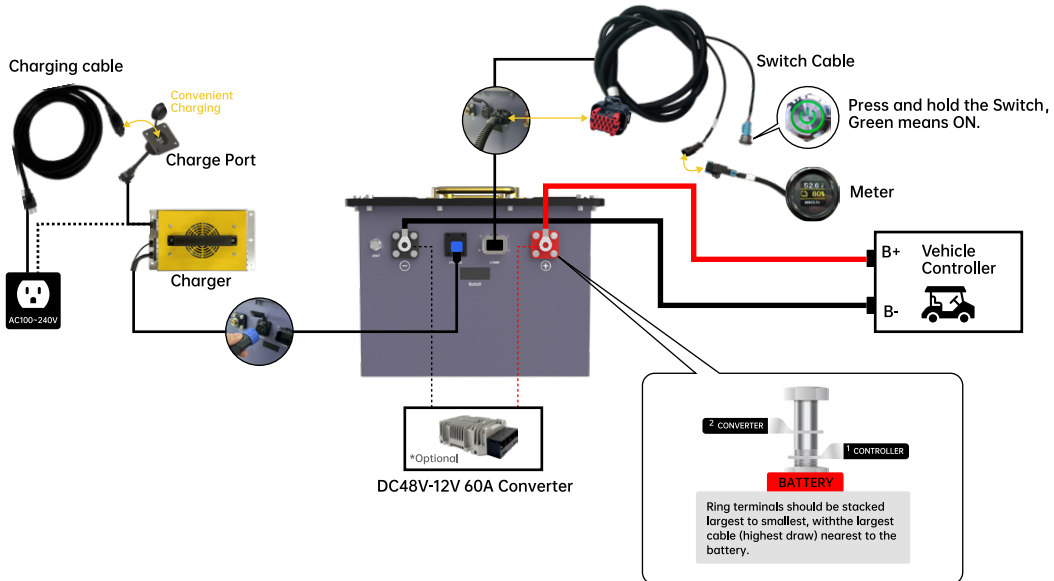

INSTALLATION-EZGO(TXT)

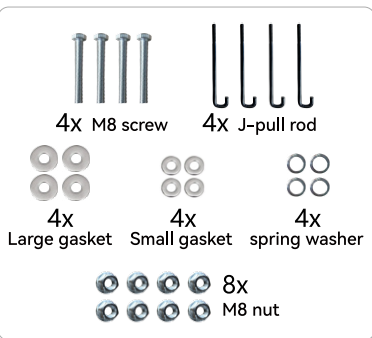

01

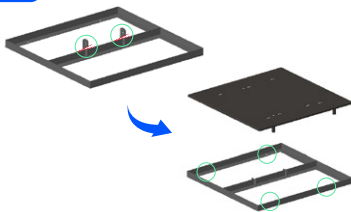

Cut off the fixing ears on the battery tray of the frame and punch 4 holes in the battery tray.

02

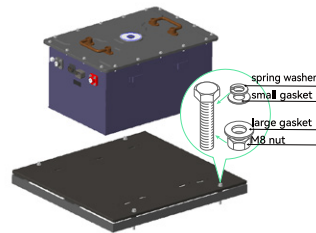

the bracket is fixed on the tray with 4x M8 screws, and then the battery is placed onto the stand.

03

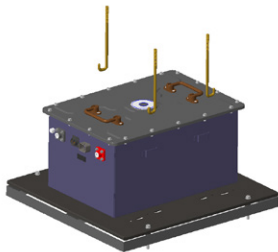

Attach the 3x J-pull rod to the battery holder.

04

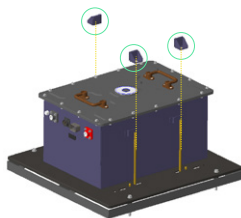

Attach the 3 fixing blocks to the battery mounting ears, and at the same time attach the 3x J-pull rod through the hole of the retaining block.

05

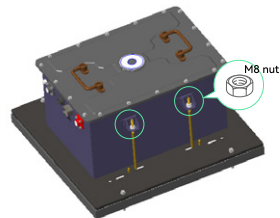

Use the nut of 3x M8 nut to lock on the tie rod and press the fixing block to reach fixed battery purpose.

INSTALLATION-EZGO(RXV)



01

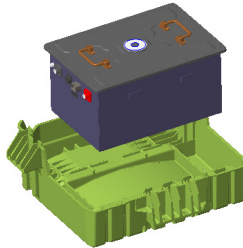

Place the battery on the battery tray of the vehicle.

02

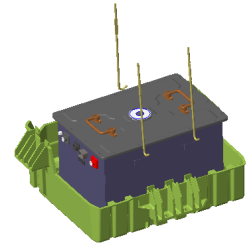

Fix the 3x J-pull rod to the battery tray.

03

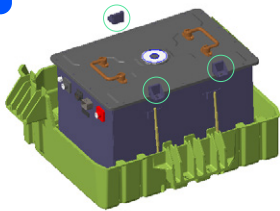

Install the three retainers to the battery mounting ears, and pass the 3x J-pull rod through the holes in the retainers.

04

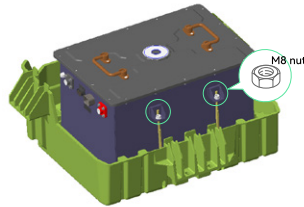

Lock the J-pull rod with the nut of 3x M8 nut and press the fixed block to achieve the purpose of fixing the battery.

INSTALLATION-YAMAHA(G29)



2X Power Cable
P+ / P- extension cable

01

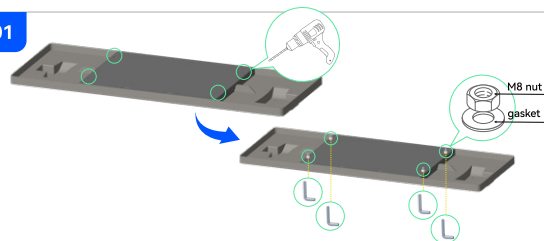

Place the bracket inside the battery compartment, align it with the mounting holes, and drill four positioning holes in the battery compartment's bottom plate. Use 4x L-shaped screws to pass through the bottom holes and secure with 4x M8 nuts.

02

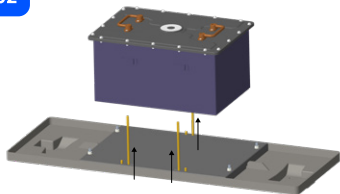

Insert 3x J-pull rods through the bottom, secure to the battery bracket, and then place the battery on the bracket.

03

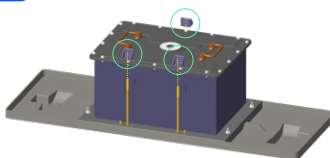

Install three mounting blocks onto the battery hanging ears, and thread the rod through the holes in the mounting blocks.

04

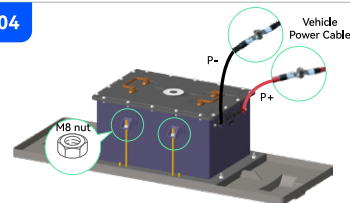

Use 3x M8 nuts to secure the rod, ensure that the fixing block is firmly connected to the battery, and then use 2x M6*12 screws to connect the power extension cable to the vehicle power cable.

INSTALLATION-CLUBCAR Precedent



4X M8 screw



3X J-pull rod



4X gasket



7X M8 nut

01



Put the bracket into the battery tray and position it.

02

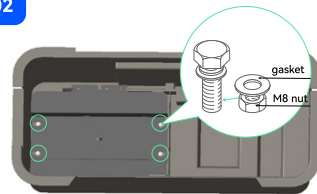

Punch 4 holes in the battery tray and use 4x M8 screws for the support Secure to the tray.

03

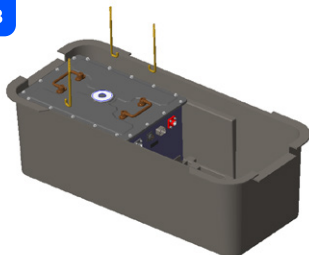

Place the battery on the bracket, and secure the 3x J-pull rod to the bracket.

04

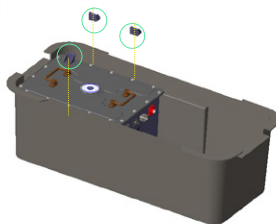

Install the three retainers to the battery mounting ears, and pass the 3x J-pull rod through the holes in the retainers.

05

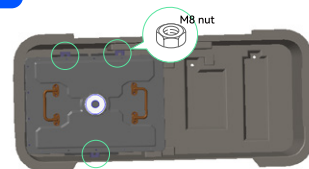

Use the nut of 3x M8 nut to lock on the J-pull rod and press the fixing block to fix the battery.

PHONE APPLICATION



Olelon Connect APP

Download The Olelon Connect App to monitor your battery's State-of-Charge.

This mobile app connects to your battery through Bluetooth connection.

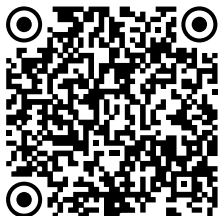

 [IOS Download](#)

 [Android Download](#)

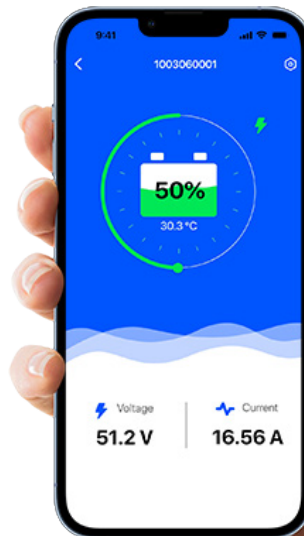



www.olelonenergy.com

Olelon Energy Company Limited
📍 624 Douglas Ave, Altamonte Springs, FL 32714.